

1519 E. Chapman Avenue, #A
Fullerton, California 92831
(714) 871-8711 Fax (714) 871-8712

**Titan Environmental
Solutions, Inc.**

Fax

To: Mr. Bryan Mann	From: Valerie Ontiveros
Co:	Pages:
Fax: 888-875-6779	Date: April 14, 2008
Phone:	Project #
Re: Procedure 5 Letter	
<input type="checkbox"/> For Review <input type="checkbox"/> Please Reply <input type="checkbox"/> Your Sampling Results <input type="checkbox"/> Your Report	

Good Afternoon Mr. Mann,

Attached to this fax is the Procedure 5 letter for the subject property located at 7803 Puritan St., Downey, CA 90242. If you have any questions or need further information please contact me at (714) 871-8711.

Thank you & have a great day!

Valerie Ontiveros



TITAN ENVIRONMENTAL SOLUTIONS, INC.

April 11, 2008

South Coast Air Quality Management District Headquarters
21865 East Copely Drive
Diamond Bar, California 91765-4182

RE: PROCEDURE-5 ASBESTOS SITE CLEAN-UP PLAN
Griffin Residence
7803 Puritan Street
Downey, California 90242
SCAQMD Notice to Comply No.: D16352
SCAQMD Approval No.: Pending

Dear Sir or Madam:

Titan Environmental Solutions, Inc is submitting a Procedure-5 work plan on behalf of Bill Griffin in an effort to comply with SCAQMD. This abatement action is categorized as a Procedure-5 based on the condition of the asbestos-containing materials identified in the asbestos survey/Assessment and the need to modify standard abatement protocol due to current site conditions.

On April 5th of 2008, a Titan Environmental representative arrived on site to perform an Asbestos survey/assessment of suspect materials that were impacted by the recent renovation activities. The Titan Environmental Representative collected a total of twenty seven PLM bulk samples and submitted to an approved NVLAP laboratory for analysis, the results are as follows, Acoustic Ceiling Material 3% Chrysotile, Linoleum Flooring 70% Chrysotile & a six inch by eight foot transite vent pipe was assumed these materials were scattered throughout the entire property including the crawl space. Titan Environmental recommended to the owner Mr. Griffin a procedure 5 clean up due to the condition of the asbestos containing materials identified in the survey.

Findings:

The following materials were found to contain asbestos in concentrations greater than 1%

White Acoustic Ceiling Material (dispersed throughout the interior and exterior of the house including the crawl space)
Approximately 3,400 sq. ft.

Linoleum Flooring Material (Throughout kitchen)
Approximately 200 sq. ft.

4 Inch Transite Pipe (In construction debris pile at the Southeast corner of property)
Approximately 5 sq. ft.

The results of this sampling can be found as an attachment to this document.

Griffin Residence
7803 Puritan Street, Downey, California 90242
April 11, 2008

The work covered by this Procedure-5 Plan includes furnishing all required labor, equipment, materials, and transportation necessary for the proper and safe removal/decontamination, handling, and disposal of the listed materials found within the inside and outside of the subject property during this project. Work shall be performed in accordance with applicable regulations and the following procedure outline.

Background Information:

Source:	Renovation
Type of damage:	Physical,
Date of renovation	March 2008
Date of survey:	April 5 th , 2008
Contractor	Sky Blue Environmental, Inc.
Consultant	Titan Environmental Solutions, Inc. Robert Menald 714-871-8711

Building Information:

Type:	Single Family Residence – Single Story
Circa:	1970-80's
Size:	Approximately 1,900 S.F. total

Impacted Area(s):

- Approximately 3,400 sq. ft. of acoustic ceiling material is scattered in various locations throughout the, interior and exterior of the residence including the crawl space.
- Approximately 200 sq. ft. of linoleum flooring material was found in the kitchen
- Approximately 1,200 sq ft of ducting throughout the plenum.
- A 6 Inch X 8 Foot transite pipe was found in construction debris pile at the southeast corner of the backyard.

Property Occupancy:

The impacted area(s) of the subject property are now vacant; Titan Environmental advised Mr. Griffin to stop all work seal up, lock all doors and windows throughout the house. The majority of contents within impacted area(s) were present at the time of the site visit.

Scope of Work:

- Removal and disposal of all acoustic ceiling material, transite pipe and construction debris piles outside of the residents as asbestos waste within a regulated area (Approximately 1,400 sq. ft.).
- Removal and disposal of all acoustic ceiling material and linoleum flooring throughout the interior of the residents as asbestos waste within a full containment (Approximately 2,000 sq. ft.).
- Removal and disposal of all ducting throughout the interior of the residents as asbestos waste within a full containment (Approximately 1,200 sq. ft.).
- To prevent asbestos fibers from being re-suspended, the ACM should be wet down with amended water.
- Large pieces of ACM shall be picked up and burrito-wrapped in 6 mil plastic sheeting, labeled as asbestos containing material and disposed of as asbestos waste by the abatement contractor.

- Small asbestos pieces of debris should be properly wetted placed in six (6) mil poly bags (double bagged), sealed, labeled and disposed of as asbestos waste.
- Soil in affected crawl space area(s) shall be raked, and placed into double 6 mil poly bags (double bagged), sealed, labeled and disposed of as asbestos waste.
- Hard surfaced/non-porous building surfaces will be wet-wiped (Approximately 5,500 sq. ft. of surface area).
- Removal and disposal of remaining contaminated soft/porous contents and electronics/appliances as asbestos contaminated waste (Approximately 5 cu. yd.).
- Remove and disposal of carpet and carpet pad as asbestos contaminated waste.

Mobilization:

The mobilization phase, which includes agency notifications and staging of supplies, will take place once a verbal notice to proceed has been issued and this Procedure-5 has been approved by SCAQMD.

A. Agency Notifications: This regulatory notice allows for notification to the proper governmental agencies of work to be performed, prior to starting date.

- SCAQMD (Emergency)
- Cal-OSHA (24-Hr.)

B. Staging of Supplies: Supplies will be staged in a neat and orderly manner and will be coordinated with the designated Owner's Representative.

Governing Regulations:

All work performed by the Contractor will be in accordance with these written procedures. In conducting our research, we have collaborated with the governmental regulatory agencies including the U.S. Environmental Protection Agency (U.S. EPA), the U.S. Occupational Safety and Health Administration (OSHA), the State of California Department of Health Services (DHS), the California Department of Industrial Relations Division of Occupational Safety and Health (Cal/OSHA), and the National Institute of Occupational Safety and Health (NIOSH).

Our work procedures are planned, documented, and performed in compliance with the following regulations and specifications:

Code of Federal Regulations (CFR) Publications

- 29 CFR 1910.134 Respiratory Protection
- 29 CFR 1910.145 Specifications for Accident Prevention Signs and Tags
- 29 CFR 1926.1101 Asbestos
& 1926.58
- 40 CFR 61. Subpart A General Provisions
- 40 CFR 61. Subpart B National Emission Standard for Hazardous Air Pollutants

California Code of Regulations (CCR)

- Title 8
- 8 CCR 341.6 TO 341.15
- 8 CCR 1529

Griffin Residence
7803 Puritan Street, Downey, California 90242
April 11, 2008

American National Safety Institute (ANSI) Publications
-ZP.279 Fundamentals Governing the Design and Operation
of Local Exhaust systems
-Z88.280 Practices for Respiratory Protection

American Society for Testing and Materials (ASTM)

National Institute for Occupational Safety and Health (NIOSH)
77-173 NIOSH Occupational Exposure sampling Strategy Manual

South Coast Air Quality Management District Rule 1403SCAQMD HEPA negative air machine permits, proper emergency notification, proof of payment and worker certifications will be submitted to SCAQMD prior to commencement of work.

Personal Air Monitoring: (Contractor)

Personal sampling is conducted during the abatement project to determine employee's exposure (outside any respirator) to airborne fibers. Representative, daily personal monitoring during the abatement project is required by (OSHA Asbestos Standard Title 8 1529 and 29 CFR 1926.1101) and the contractor's work policy. Moreover, every contractor worker shall have the right to know the asbestos concentrations to which they are exposed and what measures are being taken to protect them. This information will be made available to the employee on a daily basis. Also, results of personal sampling shall be used to select proper respiratory protection for the abatement worker. Data from personal monitoring can be used as an indication of effective removal and control techniques, which result in the lowest employee exposure.

Respiratory \ Worker Protection: (Contractor)

Respiratory protection for this project will be HEPA filtered respirators. All personnel will be required to wear proper protective clothing, which will include hooded Tyvek suits, gloves, and boots. The contractor will be responsible for total compliance with all applicable OSHA guidelines including but not limited to: 29 CFR 1926.1101 and Title 8 1529.

GENERAL APPROACH

Decontamination and Gross Removal:

This process will involve the thorough decontamination and gross removal of the impacted areas throughout the interior and exterior of the property in accordance with all applicable Federal, State, and Local regulations. All critical barriers will be sealed; a 3-stage decontamination unit will be constructed for entry/exit, the interior of the residents will be placed under negative air pressure utilizing negative air machines with HEPA filtration. The contractor will then proceed to conduct necessary gross removal and clean-up utilizing manual/wet methods (see Scope of Work). Upon completion of initial clean-up, HEPA vacuuming and wet wiping of all surfaces starting from top to bottom will begin. At this point the on-site consultant will visually inspect the affected work area(s) to determine if all debris and visible dust has been removed and bagged for disposal. Upon passing "final visual review," air clearance samples will be collected only inside the resident's containment and analyzed by the consultant utilizing phase-contrast microscopy (PCM) to determine if the decontamination work is complete. When the clearance criteria has been met (<0.01 f/cc), the contractor will then encapsulate the interior of the containment.

Air Monitoring:

Air monitoring will take place while the entire abatement procedures; the locations for the sampling pumps will be at the discretion of that on-site representative.

Griffin Residence
7803 Puritan Street, Downey, California 90242
April 11, 2008

A Certified Site Surveillance Technician (CSST) and/or a Certified Asbestos Consultant (C.A.C.) representing the owner shall perform a final visual inspection, air clearance sampling, soil sampling (crawl space) and TEM Dust MicroVac sampling. Clearance levels shall be less than 0.01 fibers per cubic centimeters (f/cc) for PCM air samples.

Worker Decontamination:

The contractor will have a 3-stage decontamination unit on-site. The contractor will be responsible for total compliance with all applicable OSHA guidelines including but not limited to: 29 CFR 1926.1101 and Title 8 1529.

Transport and Disposal:

All asbestos containing and asbestos contaminated materials removed from the site will be properly characterized and labeled and bagged as asbestos waste and placed into a disposal bin for transport to a disposal site. The waste material will be properly manifested prior to removal from the project site and signed for by a representative of the owner.

Certified Asbestos Consultant (C.A.C.)

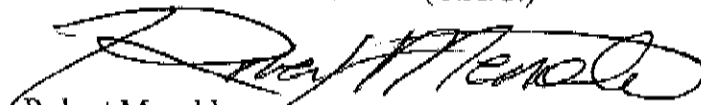

Robert Menald,
DOSH CAC No. 94-1509

Griffin Residence
7803 Puritan Street, Downey, California 90242
April 11, 2008

SCAQMD
(NEG AIR REG. NUMBERS)

Griffin Residence
7803 Puritan Street, Downey, California 90242
April 11, 2008

SCAQMD
(PROCEDURE-5 NOTIFICATION W/ PROOF OF PAYMENT)

Griffin Residence
7803 Puritan Street, Downey, California 90242
April 11, 2008

ASBESTOS REPORT

TABLE 1 ASBESTOS ANALYTICAL RESULTS

Subject Property:

**7803 Puritan Street,
Downey, CA 90242**

The following homogeneous building material types were sampled as part of this survey and their results are summarized in the table below:

SAMPLE NO.	MATERIAL DESCRIPTION	SAMPLE LOCATION	F/NF ¹	COND. ²	% ACM	# SAMP.	APPX. QUANTITY
0405-01-01 0405-01-02 0405-01-03	Plaster Wall	W. end of the Living Room's S. Wall Center of Bedroom #2's S. Wall S. end of Bedroom #1's E. Wall	F	Significantly Damaged	ND	3	6,690 SF
0405-02-04 0405-02-05 0405-02-06	Button Board	W. end of the Living Room's S. Wall Center of Bedroom #2's S. Wall S. end of Bedroom #1's E. Wall	NF	Significantly Damaged	ND	3	6,690 SF
0405-03-07 0405-03-08 0405-03-09	Linoleum Flooring	N end of Restroom #1 W. end of Restroom #1 S.W. end of Restroom #1	NF	Significantly Damaged	ND	3	65 SF

Abbreviations: N.=North, E.=East, W.=West & S.=South
ND=None Detected

¹F = Friable; NF = Non-friable

²Cond. = Condition of Materials—Good, Damaged, or Significantly Damaged.

Note: <1% = Calif. Code of Regulations, Title 8, Section 1529, "Asbestos-containing construction material" means any manufactured construction material which contains more than one tenth of 1 percent asbestos by weight. This material will be abated as asbestos containing material; however, it may be disposed of as construction debris

ASBESTOS ANALYTICAL RESULTS Cont

Subject Property:

**7803 Puritan Street,
Downey, CA 90242**

The following homogeneous building material types were sampled as part of this survey and their results are summarized in the table below:

SAMPLE NO.	MATERIAL DESCRIPTION	SAMPLE LOCATION	F/NF ¹	COND. ²	% ACM	# SAMP.	APPX. QUANTITY
0405-04-10 0405-04-11 0405-04-12	Linoleum Paper Backing	N. end of Kitchen W. end of Kitchen Center of Kitchen	NF	Significantly Damaged	70% Chrysotile	3	330 SF
0405-05-13 0405-05-14 0405-05-15	Vapor Barrier Paper	S. end of the Family Room's W. Wall Debris pile at the S.E. of the Back Yard Debris pile at the S.W of the Back Yard	NF	Significantly Damaged	ND	3	1,950 SF
0405-06-16 0405-06-17 0405-06-18	Drywall	N. end of Family Room Closet Center of the Kitchen Pantry's N. Wall Center of the Kitchen Pantry's S. Wall	NF	Significantly Damaged	ND	3	680 SF

Abbreviations: N.=North, E.=East, W.=West & S.=South
ND=None Detected

¹F = Friable; NF = Non-friable

²Cond. = Condition of Materials-Good, Damaged, or Significantly Damaged.

Note: <1% = Calif. Code of Regulations, Title 8, Section 1529, "Asbestos-containing construction material" means any manufactured construction material which contains more than one tenth of 1 percent asbestos by weight." This material will be abated as asbestos containing material; however, it may be disposed of as construction debris.

ATTACHMENT 1
LABORATORY ANALYTICAL RESULTS



LA Testing

10772 Noel St., Los Alamitos, CA 90720

Phone: (714) 828-4939 Fax: (714) 828-4944 Email: losalamitoslab@latesting.com

Attn: Veronica Quiroz
Titan Environmental
1519 E. Chapman, A
Fullerton, CA 92831

Fax:
Project: 172308AS Griffin Residence

Phone: (714) 871-8711

Customer ID: 32TITA85
Customer PO:
Received: 04/07/08 8:00 AM
LA Testing Order: 330803182

LA Testing Proj:
Analysis Date: 4/8/2008
Report Date: 4/8/2008

Asbestos Analysis of Bulk Materials via EPA 600/R-93/116 Method using Polarized Light Microscopy

Sample	Location	Appearance	Non-Asbestos		Asbestos
			% Fibrous	% Non-Fibrous	% Type
0405-01-01 330803182-0001	West end of living room S. wall	Beige/White Non-Fibrous Heterogeneous		15% Mica 85% Non-fibrous (other)	None Detected
0405-01-02 330803182-0002	Center of bedroom #25 S. wall	Beige/White Non-Fibrous Heterogeneous		15% Mica 85% Non-fibrous (other)	None Detected
0405-01-03 330803182-0003	South end of bedroom #1 S.E. wall	Beige/White Non-Fibrous Heterogeneous		15% Mica 85% Non-fibrous (other)	None Detected
0405-02-04 330803182-0004	West end of the living room S. wall	White/Beige Fibrous Heterogeneous	5% Cellulose	15% Mica 80% Non-fibrous (other)	None Detected
0405-02-05 330803182-0005	Center of bedroom #25 S. wall	White/Brown Fibrous Heterogeneous	15% Cellulose	85% Gypsum	None Detected
0405-02-06 330803182-0006	South end of bedroom #1 S.E. wall	White/Brown Fibrous Heterogeneous	15% Cellulose	85% Gypsum	None Detected
0405-03-07 330803182-0007	North end of restroom #1	White/Gray Fibrous Heterogeneous	20% Cellulose <1% Glass <1% Synthetic	80% Non-fibrous (other)	None Detected

Analyst(s)

Fred Chappellear (27)

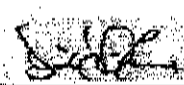
Derrick Tanner, Laboratory Manager
or other approved signatory

Due to magnification limitations inherent in PLM, asbestos fibers in dimensions below the resolution capability of PLM may not be detected. Samples reported as <1% or none detected may require additional testing by TEM to confirm asbestos quantities. The above test report relates only to the items tested and may not be reproduced in any form without the express written approval of LA Testing's. LA Testing's liability is limited to the cost of analysis. LA Testing bears no responsibility for sample collection activities or analytical method limitations. Interpretation and use of test results are the responsibility of the client. Samples received in good condition unless otherwise noted.
NVLAP Lab Code: 101384-B, Cal ELAP # 1406



LA Testing

10772 Noel St., Los Alamitos, CA 90720

Phone: (714) 838-4999 Fax: (714) 829-4944 Email: losalamitos@latesting.com

Attn: Veronica Quiroz
Titan Environmental
1519 E. Chapman, A
Fullerton, CA 92831

Fax: _____ Phone: (714) 871-8711
Project: 17Z308AS Griffin Residence

Customer ID: 32TITA85
Customer PO: _____
Received: 04/07/08 8:00 AM
LA Testing Order: 330803182
LA Testing Proj: _____
Analysis Date: 4/8/2008
Report Date: 4/8/2008

Asbestos Analysis of Bulk Materials via EPA 600/R-93/116 Method using Polarized Light Microscopy

Sample	Location	Appearance	Non-Asbestos			Asbestos
			% Fibrous	% Non-Fibrous	% Type	
0405-03-08 330803182-0008	West end of bedroom #1	White/Gray Fibrous Heterogeneous	20% Cellulose <1% Glass <1% Synthetic	80% Non-fibrous (other)	None Detected	
0405-03-09 330803182-0009	Southwest end of restroom #1	White/Gray Fibrous Heterogeneous	20% Cellulose <1% Glass <1% Synthetic	80% Non-fibrous (other)	None Detected	
0405-04-10 330803182-0010	North end of kitchen	Gray Fibrous Homogeneous	20% Cellulose	10% Non-fibrous (other)	70% Chrysotile	
0405-04-11 330803182-0011	West end of kitchen	Gray Fibrous Homogeneous	30% Cellulose	10% Non-fibrous (other)	60% Chrysotile	
0405-04-12 330803182-0012	Center of the kitchen	Gray Fibrous Homogeneous	30% Cellulose	10% Non-fibrous (other)	60% Chrysotile	
0405-05-13 330803182-0013	South end of family room W. wall	Brown Fibrous Homogeneous	81% Cellulose 4% Glass	15% Non-fibrous (other)	None Detected	
0405-05-14 330803182-0014	Debris at the south east of the backyard	Brown Fibrous Homogeneous	80% Cellulose	20% Non-fibrous (other)	None Detected	

Analyst(s)

Fred Chappelaar (27)

Derrick Tanner, Laboratory Manager
or other approved signatory

Due to magnification limitations inherent in PLM, asbestos fibers in dimensions below the resolution capability of PLM may not be detected. Samples reported as <1% or none detected may require additional testing by TEM to confirm asbestos quantities. The above test report relates only to the items tested and may not be reproduced in any form without the express written approval of LA Testing's. LA Testing's liability is limited to the cost of analysis. LA Testing bears no responsibility for sample collection activities or analytical method limitations. Interpretation and use of test results are the responsibility of the client. Samples received in good condition unless otherwise noted.
NVLAP Lab Code: 101384-0, Cal/EIAP #1406



LA Testing

10772 Noel St., Los Alamitos, CA 90720

Phone: (714) 828-4999 Fax: (714) 828-4944 Email: losalamitotestlab@lataesting.com

Attn: **Veronica Quiroz**
Titan Environmental
1519 E. Chapman, A
Fullerton, CA 92831

Fax: _____
Project: **172308AS Griffin Residence**

Phone: (714) 871-8711

Customer ID: 32TITA85
Customer PO: _____
Received: 04/07/08 8:00 AM
LA Testing Order: 330803182
LA Testing Proj: _____
Analysis Date: 4/8/2008
Report Date: 4/8/2008

Asbestos Analysis of Bulk Materials via EPA 600/R-93/116 Method using Polarized Light Microscopy

Sample	Location	Appearance	Non-Asbestos		Asbestos
			% Fibrous	% Non-Fibrous	% Type
0405-05-15 330803182-0015	Debris pile at southwest end of the backyard	Black Fibrous Homogeneous	80% Cellulose	20% Non-fibrous (other)	None Detected
0405-06-16 330803182-0016	North end of family room closet	White/Brown Fibrous Heterogeneous	20% Cellulose	80% Gypsum	None Detected
0405-16-17 330803182-0017	Center of the kitchen pantry north wall	White/Brown Fibrous Heterogeneous	20% Cellulose	80% Gypsum	None Detected
0405-16-18 330803182-0018	Center of the kitchen pantry south wall	White/Brown Fibrous Heterogeneous	20% Cellulose	80% Gypsum	None Detected
0405-07-19 330803182-0019	North end of family room closet	White Non-Fibrous Homogeneous		90% Ca Carbonate 10% Non-fibrous (other)	<1% Chrysotile
0405-07-20 330803182-0020	Center of the kitchen pantry north wall	White Non-Fibrous Homogeneous		90% Ca Carbonate 10% Non-fibrous (other)	<1% Chrysotile
0405-07-21 330803182-0021	Center of the kitchen pantry south wall	White Non-Fibrous Homogeneous		90% Ca Carbonate 10% Non-fibrous (other)	<1% Chrysotile
0405-08-22 330803182-0022	South east corner of living room ceiling	White Fibrous Homogeneous		5% Mica 92% Non-fibrous (other)	3% Chrysotile

Analyst(s)

Fred Chappelaar (27)

Denick Turner, Laboratory Manager
or other approved signatory

Due to magnification limitations inherent in PLM, asbestos fibers in dimensions below the resolution capability of PLM may not be detected. Samples reported as <1% or none detected may require additional testing by TEM to confirm asbestos quantities. The above test report relates only to the items tested and may not be reproduced in any form without the express written approval of LA Testing's. LA Testing's liability is limited to the cost of analysis. LA Testing bears no responsibility for sample collection activities or analytical method limitations. Interpretation and use of test results are the responsibility of the client. Samples received in good condition unless otherwise noted.

NVLAP Lab Code 101384-0, Cal ELAP #1408



LA Testing

10772 Noel St., Los Alamitos, CA 90720

Phone: (714) 828-4939 Fax: (714) 828-4944 Email: losalamitos@lataesting.com

Attn: **Veronica Quiroz**
Titan Environmental
1519 E. Chapman, A
Fullerton, CA 92831

Fax: _____ Phone: (714) 871-8711
Project: 172308AS Griffin Residence

Customer ID: 32TITA85
Customer PO: _____
Received: 04/07/08 8:00 AM
LA Testing Order: 330803182
LA Testing Proj: _____
Analysis Date: 4/8/2008
Report Date: 4/8/2008

Asbestos Analysis of Bulk Materials via EPA 600/R-93/116 Method using Polarized Light Microscopy

Sample	Location	Appearance	Non-Asbestos		Asbestos
			% Fibrous	% Non-Fibrous	% Type
0405-08-23 330803182-0023	Debris pile next to entrance door at N.W. corner	White Fibrous Homogeneous		98% Non-fibrous (other)	2% Chrysotile
0405-08-24 330803182-0024	Debris pile at N.E. corner of bedroom #1	Beige Fibrous Homogeneous		5% Mica 92% Non-fibrous (other)	3% Chrysotile
0405-09-25 330803182-0025	Debris pile at the center of the telephone data	White/Beige Fibrous Heterogeneous	60% Cellulose 35% Min. Wood	5% Non-fibrous (other)	None Detected
0405-09-26 330803182-0026	Debris pile at the southwest end of kitchen	White/Beige Fibrous Heterogeneous	60% Cellulose 35% Min. Wood	5% Non-fibrous (other)	None Detected
0405-09-27 330803182-0027	South west corner of restroom #1	Beige Fibrous Homogeneous	95% Cellulose	5% Non-fibrous (other)	None Detected

Analyst(s)

Fred Chapplear (27)

Derrick Tanner, Laboratory Manager
or other approved signatory

Due to magnification limitations inherent in PLM, asbestos fibers in dimensions below the resolution capability of PLM may not be detected. Samples reported as <1% or none detected may require additional testing by TEM to confirm asbestos quantities. The above test report relates only to the items tested and may not be reproduced in any form without the express written approval of LA Testing's. LA Testing's liability is limited to the cost of analysis. LA Testing bears no responsibility for sample collection activities or analytical method limitations. Interpretation and use of test results are the responsibility of the client. Samples received in good condition unless otherwise noted.

NVLAP Lab Code: 1013840, Cal ELAP # 1406

ATTACHMENT 2
CHAIN OF CUSTODY

Sample Number	Material	Location	Quantity
0405-01	PLASTER WALL	WEST END OF THE LIVING ROOMS S. WALL	
↓	↓	↓	↓
02		CENTER OF THE BEDROOM #25 SOUTH WALL	6.690SF
↓	↓	↓	↓
03		SOUTH END OF THE BEDROOM #15 S. WALL	
0405-04	BUTTON BOARD	WEST END OF THE LIVING ROOMS SOUTH WALL	
↓	↓	↓	↓
05		CENTER OF THE BEDROOM #25 SOUTH WALL	6.690SF
↓	↓	↓	↓
06		SOUTH END OF THE BEDROOM #15 S. WALL	
0405-07	LINOLEUM FLOORING	NORTH END OF THE BEDROOM #1	
↓	↓	↓	↓
08		WEST END OF THE BEDROOM #1	6.55SF
↓	↓	↓	↓
09		SOUTHWEST END OF THE BEDROOM #1	
0405-10	LINOLEUM FLOORING	NORTH END OF THE KITCHEN	
↓	↓	↓	↓
11		WEST END OF THE KITCHEN	3.30SF
↓	↓	↓	↓
12		CENTER OF THE KITCHEN	
0405-13	VAPOR BARRIER	SOUTH END OF THE FAMILY ROOMS S. WALL	
↓	↓	↓	↓
14		DECK AT THE SOUTH EAST OF THE PORCH PILE AT THE EAST END OF THE BACKYARD	9.50SF
↓	↓	↓	↓
15		DECK PILE AT THE EAST END OF THE BACKYARD	
0405-16	DRYWALL	WEST END OF FAMILY ROOMS S. WALL	
↓	↓	↓	↓
17		CENTER OF THE KITCHEN CENTER NORTH WALL	6.80SF
↓	↓	↓	↓
18		CENTER OF THE KITCHEN CENTER NORTH WALL	
0405-19	JOINT COMPOUND	SOUTH END OF THE FAMILY ROOMS S. WALL	
↓	↓	↓	↓
20		CENTER OF THE KITCHEN CENTER NORTH WALL	6.80SF
↓	↓	↓	↓
21		CENTER OF THE KITCHEN CENTER NORTH WALL	
0405-22	BRICKS	SOUTH EAST CORNER OF THE LIVING ROOMS S. WALL	
↓	↓	↓	↓
23		DECK PILE NEXT TO ENTRANCE DOOR AT THE N. WALL OF THE BEDROOM #1	10SF
↓	↓	↓	↓
24		DECK PILE AT THE N. WALL OF THE BEDROOM #1	

Requisition Received
 Requisition Received
 Requisition Received

Paul M. ...

Date: 4/7/08
 Date:
 Date:
 Date:

Time: 6:00A
 Time:
 Time:
 Time:

FIGURE 1
SITE DRAWING

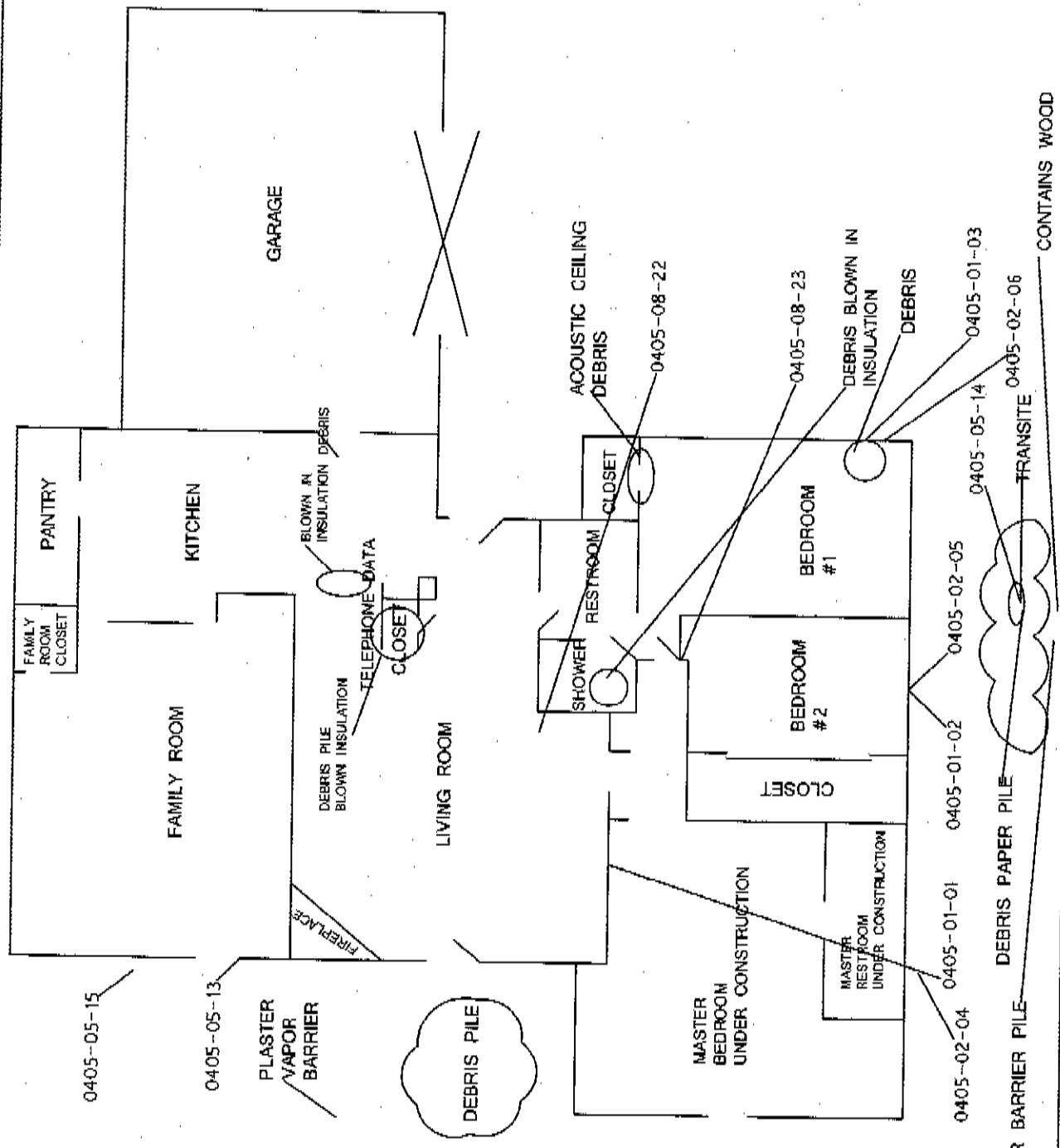

TITAN ENVIRONMENTAL SOLUTIONS, INC. 1519 E. CHAPMAN AVENUE, SUITE-A FULLERTON, CA. 92831		GRIFFIN RESIDENCE LIMITED ASBESTOS SURVEY 7803 PURITAN STREET DOWNEY CA 90242	
DATE:	04-5-08	PROJ NO.:	172308-AS
FIGURE:	FIG-1	DRAWN BY:	Veronica
SCALE:	NTS	CHECK BY:	ROBERT