

FLOOR PLAN AREAS
SCALE: 1/4"=1'-0"

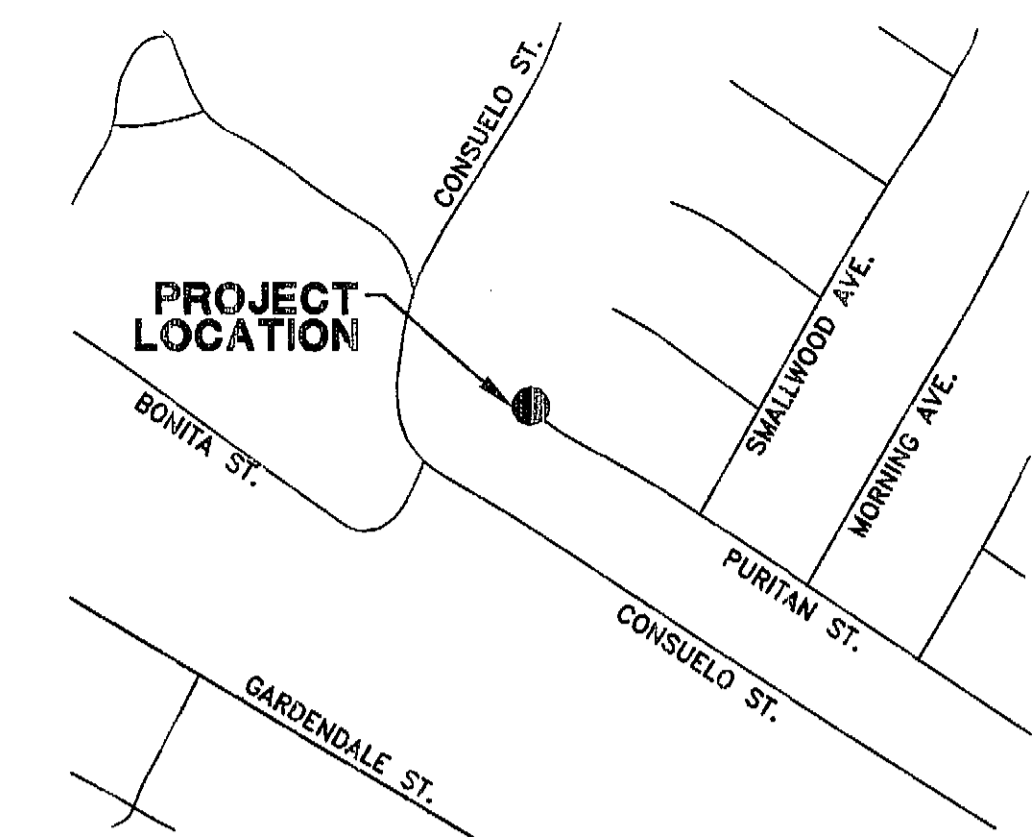

VICINITY MAP
NO SCALE

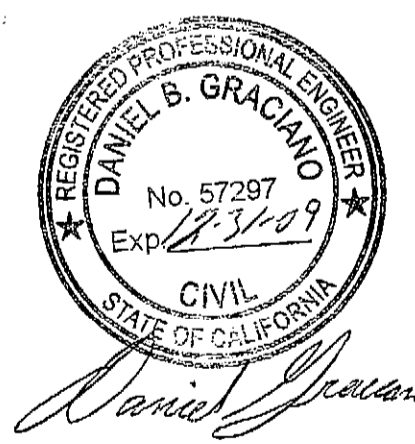
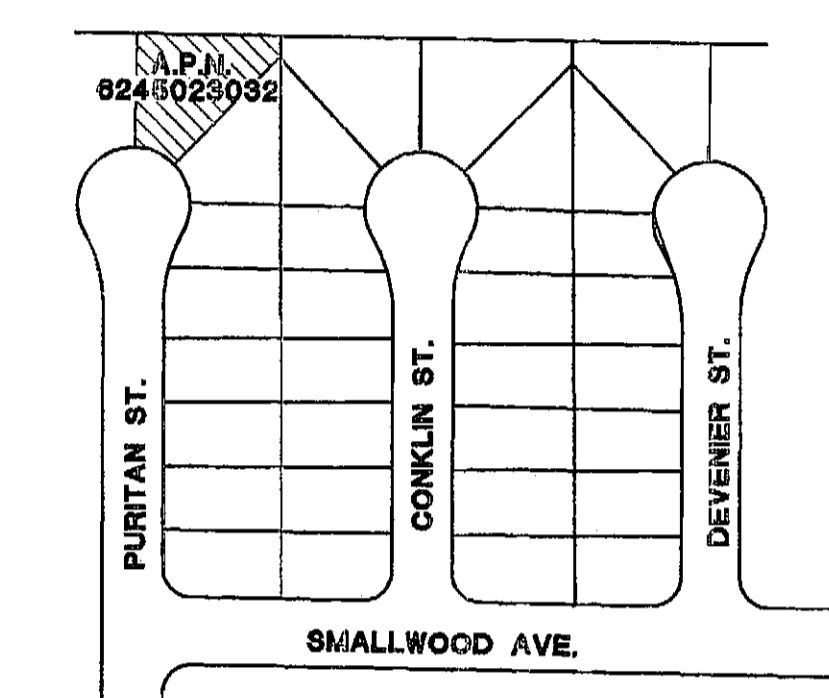

LOCATION MAPS
NO SCALE

REVISIONS	BY

GRIFFIN, WILLIAM & MARLENE
HOME IMPROVEMENTS
1803 PURITAN ST.
DOWNEY, CA 90242

FLOOR PLAN AREAS

DATE	05-25-09
SCALE	AS SHOWN
DRAWN	R.S.
JOB	GRIFFIN
SHEET	9
OF 9 SHEETS	

CULTEC, Inc.
 878 Federal Road
 P.O. Box 280
 Brookfield, CT 06804, USA
 Phone: 203-775-4416
 Toll Free: 1-800-4-CULTEC (1-800-428-5832)
 Fax: 203-775-1462
 Email: custservice@cultec.com

Contactor® & Recharger® Chamber

The Contactor® Chamber series consists of lower profile, lower capacity chambers and are typically used for installations with depth restrictions or when a larger installation area is required. Conventional manholes must be used with this series.
 The Recharger® series consists of higher profile, higher capacity chambers. When using this series, less chambers are required resulting in less labor and a smaller installation area. Heavy Duty (HD) versions must be used for traffic applications.
 Our most popular and cost-effective models used for storm water are the 100, 150, 280, 330XL and V8.
 Recharger 330 is available for non-domestic use only. All domestic designs are to use the Recharger 330XL.



Model #	Model Name	Length	Installed Length	Width	Height	Min. Storage Capacity Surrounded by Stone
C-4	Contactor® Field Drain™ C-4	8.50 ft	8.00 ft	46 inches	8.50 inches	35.99 #/Unit
E Z-24	Contactor® E Z-24	2.59 m	2.44 m	1168 mm	216 mm	0.55 m³/Unit
100	Contactor® 100	8.00 ft	7.40 ft	36 inches	12.60 inches	28.85 #/Unit
125	Contactor® 125	7.50 ft	6.25 ft	30 inches	18.00 inches	25.16 #/Unit
150	Recharger® 150	8.50 ft	7.50 ft	33 inches	18.50 inches	36.71 #/Unit
180	Recharger® 180	2.59 m	2.29 m	838 mm	470 mm	1.24 m³/Unit
280	Recharger® 280	7.33 ft	6.33 ft	36 inches	20.50 inches	35.32 #/Unit
330	Recharger® 330	2.23 m	1.93 m	914 mm	521 mm	1.00 m³/Unit
330 XL	Recharger® 330 XL	8.00 ft	7.00 ft	47 inches	36.50 inches	64.46 #/Unit
V8	Recharger® V8	2.44 m	2.29 m	623 mm	673 mm	4.38 m³/Unit

12/7/2009 Page 1 of 2

TECHNICAL GENIE® The Chamber With The Strip™

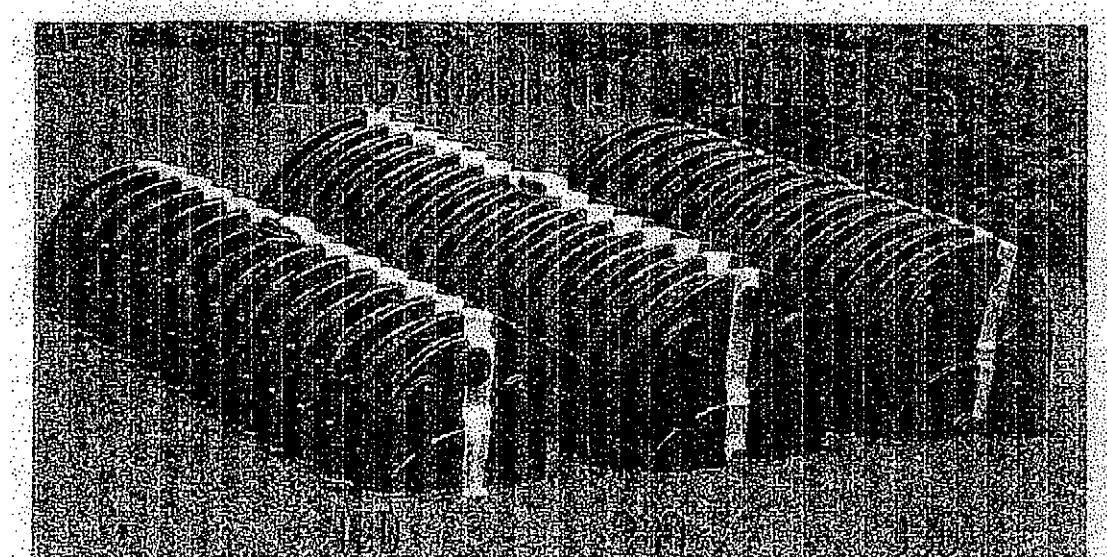

CULTEC Recharger® Chambers are designed for underground stormwater detention or retention or may be used for septic leach fields.
 All models come in Heavy Duty HD for use in traffic and non-traffic applications. Their higher profiles work well for applications of large volumes or that need to be contained in smaller areas. The perforated sidewalls and full open bottoms allow for maximum infiltration capability.
 When used with CULTEC No. 410™ Filter Fabric, Recharger® chambers can be used as gravel-less leach fields.

For stormwater, their sub-surface installation saves space while offering design flexibility.

Our unique patented rib connection, found only on CULTEC chambers, makes installation fast and easy. Backfilling reinforces this connection. Recharger® chambers are lightweight and easy to move around the job site. One or two workers can manually place the units, therefore, heavy equipment use is kept to a minimum and there is less land disturbance.

CULTEC chambers are superior to others because they have an integral, fully formed endwall. No additional end plates or parts are required.

	Recharger® 180	Recharger® 280	Recharger® 330
Height	20.5"	26.5"	30.5"
Invert Height	14"	20.37"	24"
Width	36"	47"	52"
Length	7.33'	8.0'	8.5'
Lay-up Length	6.33'	7.0'	6.25'
Capacity	189.19 gal	363.88 gal	417.44 gal
Capacity	25.3 C.F.	48.6 C.F.	55.8 C.F.
One unit covers about	400 S.F.	780 S.F.	900 S.F.

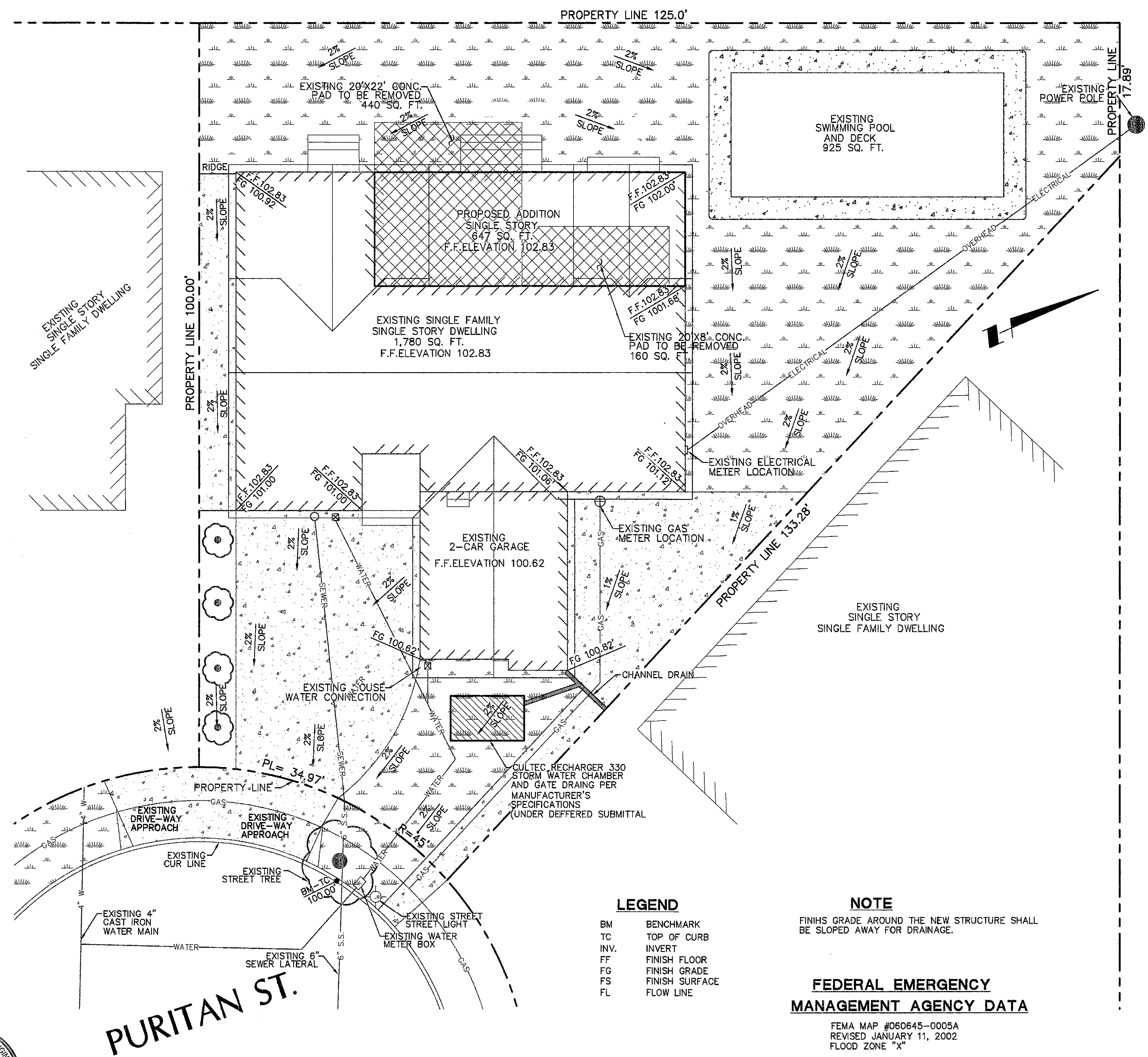

DRAINAGE PLAN
 SCALE: 1/8"=1'-0"

STORM WATER CHAMBER
 A STORM WATER CAPTURE SYSTEM MUST BE DESIGNED AND INSTALLED PRIOR TO ISSUANCE OF FINAL. ALL WORK SHALL BE PER CITY OF DOWNEY REQUIREMENTS. STORM WATER CAPTURE SYSTEM SPECIFICATIONS AND DETAILS SHALL BE DONE BY "CULTEC" AS A SEPARATE DEFERRED SUBMITTAL.

- LEGEND**
- BM BENCHMARK
 - TC TOP OF CURB
 - INV. INVERT
 - FF FINISH FLOOR
 - FG FINISH GRADE
 - FS FINISH SURFACE
 - FL FLOW LINE

NOTE
 FINISH GRADE AROUND THE NEW STRUCTURE SHALL BE SLOPED AWAY FOR DRAINAGE.

FEDERAL EMERGENCY MANAGEMENT AGENCY DATA
 FEMA MAP #060645-0005A
 REVISED JANUARY 11, 2002
 FLOOD ZONE "X"

LEGAL DESCRIPTION
 TRACT NO 18511 LOT 104

LA COUNTY ASSESSOR'S PARCEL NUMBER
 6245-023-032

SITE ADDRESS
 7803 PURITAN ST. DOWNEY, CA 90242

REVISIONS	BY

GRiffin, WILLIAM & MARLENE
 HOME IMPROVEMENTS
 1803 PURITAN ST.
 DOWNEY, CA 90242

DRAINAGE PLAN

DATE	05-25-09
SCALE	AS SHOWN
DRAWN	R.G.
JOB	GRIFFIN
SHEET	8
OF 9 SHEETS	

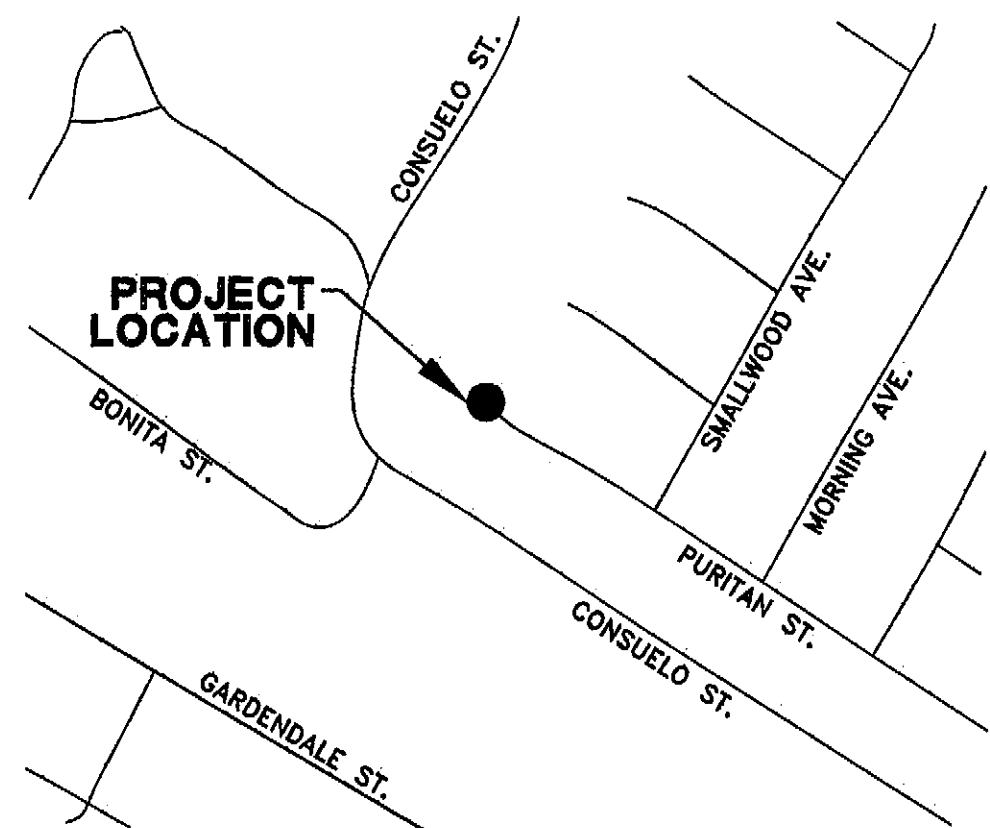

VICINITY MAP
NO SCALE

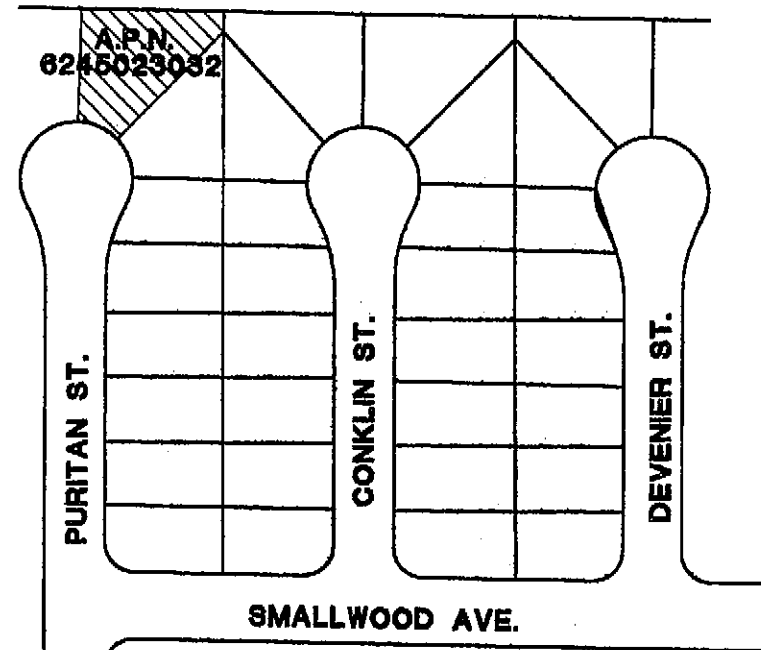

LOCATION MAPS
NO SCALE

SPECIAL INSPECTION FOR SEISMIC RESISTANCE IS REQUIRED FOR THIS PROJECT. PROVIDE SPECIAL INSPECTION FOR THE FOLLOWING:

SEISMIC DESIGN CATEGORY	SPECIAL INSPECTION REQUIRED
C, D, E, AND F	STRUCTURAL WOOD* EPOXY SET HARDWARE

EPOXY USED SHALL BE "HILTI" RESOQ SD 100-25 ESR 2522.

SPECIAL INSPECTION FOR SEISMIC RESISTANCE

NO SCALE



SHEET INDEX

SHEET NO.	DESCRIPTION
1.	TITLE SHEET, VICINITY MAP, PARCEL MAP, AND SITE PLAN
2.	FLOOR PLAN
3.	ELEVATIONS
4.	FOUNDATION PLAN AND DETAILS
5.	FRAMING PLAN AND DETAILS
6.	BUILDING SECTIONS AND DETAILS
7.	TITLE 24 ENERGY FORMS
8.	DRAINAGE PLAN
9.	FLOOR AREA DETAIL

REVISIONS	BY

CONSTRUCTION DRAWINGS FOR GRIFFIN RESIDENCE COMPLETE HOME RE-CONSTRUCTION AND ADDITION, NEW GAME ROOM, BATHROOM, AND PATIO COVER

FIRE PROTECTION SPRINKLERS

A FIRE PROTECTION SPRINKLER SYSTEM MUST BE DESIGNED AND INSTALLED PRIOR TO ISSUANCE OF FINAL. ALL WORK SHALL BE PER CITY OF DOWNEY REQUIREMENTS. FIRE SPRINKLER DESIGN SHALL BE DONE BY OTHERS IN A DEFERRED SUBMITTAL.

LOT COVERAGE

LOT	9,600 SQ. FT.
EXISTING DWELLING TO BE RE-CONSTRUCTED	1,490 SQ. FT.
EXISTING FRONT PORCH TO BE RE-BUILT	59 SQ. FT.
EXISTING 2-CAR GARAGE TO BE RE-CONSTRUCTED	452 SQ. FT.
PROPOSED ADDITION TO HOME	646 SQ. FT.
TOTAL	3,197 SQ. FT.
FINAL CONDITION LOT USE PERCENTAGE	3,197 SQ. FT./9,600 SQ. FT. = 32.7%

STRUCTURAL OBSERVATION BY ENGINEER OF RECORD

THE FOLLOWING ITEMS MUST BE OBSERVED AND INSPECTED BY ENGINEER OF RECORD PRIOR TO CALLING CITY INSPECTOR FOR INSPECTION.

- FOUNDATION WORK AND HARDWARE PLACEMENT PRIOR TO POURING CONCRETE.

DANIEL GRACIANO P.E. DATE

- EPOXY SET ANCHOR BOLTS AND HOLD DOWNS LOCATION AND DEPTHS

DANIEL GRACIANO P.E. DATE

- FRAMING INSPECTION, SHEAR PANEL NAILING AND BEAMS

DANIEL GRACIANO P.E. DATE

- STUCCO LATH AND MOISTURE BARRIER.

DANIEL GRACIANO P.E. DATE

STRUCTURAL OBSERVATION
NO SCALE

PROJECT ADDRESS
7803 PURITAN ST.
DOWNEY, CA 90242
A.P.N. 6245023032

OWNER INFORMATION
GRIFFIN, WILLIAM & MARLENE
7803 PURITAN ST.
DOWNEY, CA 90242
(562) 477-2054

PLANS PREPARED BY:
ROBERTO GRACIANO
'N' HOUSE DESIGN SERVICES
201 E. ARTROW HIGHWAY #65
GLENDDORA, CA 91740
(626) 437-8697

ENGINEER OF RECORD
DANEIL GRACIANO P.E. # C57297
'N' HOUSE DESIGN SERVICES
201 E. ARTROW HIGHWAY #65
GLENDDORA, CA 91740
(626) 437-8697

DESIGN LOADS

CEILING LEVEL:	
DEAD LOAD	10 PSF
DEAD LOAD	25 PSF
ROOF LEVEL:	
DEAD LOAD	10 PSF
DEAD LOAD	25 PSF

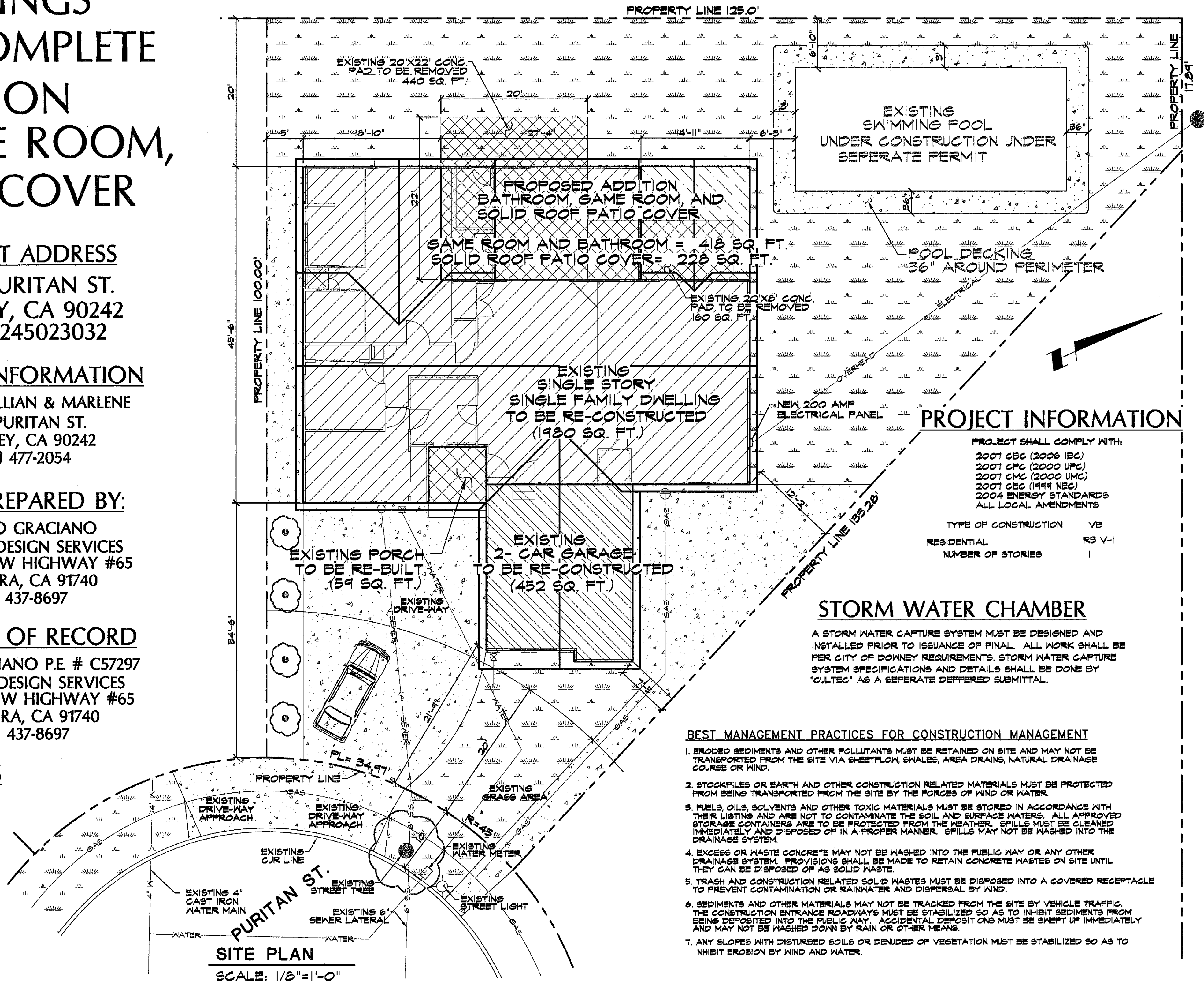

PROJECT INFORMATION

PROJECT SHALL COMPLY WITH:
2001 CBC (2006 IBC)
2001 CPC (2000 UPC)
2001 CMC (2000 UMC)
2001 CEC (1999 NEC)
2004 ENERGY STANDARDS
ALL LOCAL AMENDMENTS

TYPE OF CONSTRUCTION VB
RESIDENTIAL RS V-1
NUMBER OF STORIES 1

STORM WATER CHAMBER

A STORM WATER CAPTURE SYSTEM MUST BE DESIGNED AND INSTALLED PRIOR TO ISSUANCE OF FINAL. ALL WORK SHALL BE PER CITY OF DOWNEY REQUIREMENTS. STORM WATER CAPTURE SYSTEM SPECIFICATIONS AND DETAILS SHALL BE DONE BY "CULTEC" AS A SEPERATE DEFERRED SUBMITTAL.

BEST MANAGEMENT PRACTICES FOR CONSTRUCTION MANAGEMENT

- ERODED SEDIMENTS AND OTHER POLLUTANTS MUST BE RETAINED ON SITE AND MAY NOT BE TRANSPORTED FROM THE SITE VIA SHEETFLOW, SHALES, AREA DRAINS, NATURAL DRAINAGE COURSE OR WIND.
- STOCKPILES OF EARTH AND OTHER CONSTRUCTION RELATED MATERIALS MUST BE PROTECTED FROM BEING TRANSPORTED FROM THE SITE BY THE FORCES OF WIND OR WATER.
- FUELS, OILS, SOLVENTS AND OTHER TOXIC MATERIALS MUST BE STORED IN ACCORDANCE WITH THEIR LISTINGS AND ARE NOT TO CONTAMINATE THE SOIL AND SURFACE WATERS. ALL APPROVED STORAGE CONTAINERS ARE TO BE PROTECTED FROM THE WEATHER. SPILLS MUST BE CLEANED IMMEDIATELY AND DISPOSED OF IN A PROPER MANNER. SPILLS MAY NOT BE WASHED INTO THE DRAINAGE SYSTEM.
- EXCESS OR WASTE CONCRETE MAY NOT BE WASHED INTO THE PUBLIC WAY OR ANY OTHER DRAINAGE SYSTEM. PROVISIONS SHALL BE MADE TO RETAIN CONCRETE WASTES ON SITE UNTIL THEY CAN BE DISPOSED OF AS SOLID WASTE.
- TRASH AND CONSTRUCTION RELATED SOLID WASTES MUST BE DISPOSED INTO A COVERED RECEPTACLE TO PREVENT CONTAMINATION OR RAINWATER AND DISPERSAL BY WIND.
- SEDIMENTS AND OTHER MATERIALS MAY NOT BE TRACKED FROM THE SITE BY VEHICLE TRAFFIC. THE CONSTRUCTION ENTRANCE ROADWAYS MUST BE STABILIZED SO AS TO INHIBIT SEDIMENTS FROM BEING DEPOSITED INTO THE PUBLIC WAY. ACCIDENTAL DEPOSITIONS MUST BE SWEEP UP IMMEDIATELY AND MAY NOT BE WASHED DOWN BY RAIN OR OTHER MEANS.
- ANY SLOPES WITH DISTURBED SOILS OR DENuded OF VEGETATION MUST BE STABILIZED SO AS TO INHIBIT EROSION BY WIND AND WATER.

GRIFFIN, WILLIAM & MARLENE
HOME IMPROVEMENTS
1803 PURITAN ST.
DOWNEY, CA 90242

TITLE SHEET, VICINITY MAP, PARCEL MAP AND SITE PLAN

DATE	09-25-09
SCALE	AS SHOWN
DRAWN	R.S.
JOB	GRIFFIN
SHEET	1
OF 9 SHEETS	