

CULTEC, Inc.
 878 Federal Road
 P.O. Box 280
 Brookfield, CT 06804, USA
 Phone: 203-775-4416
 Toll Free: 1-800-4-CULTEC (1-800-428-5832)
 Fax: 203-775-1462
 Email: custservice@cultec.com

Contacto® & Recharger® Chamber

The Contacto® Chamber series consists of lower profile, lower capacity chambers and are typically used for installations with depth restrictions or when a lower infiltration area is required. Contacto® chambers must be used with 918 series.
 The Recharger® series consists of higher profile, higher capacity chambers. When using this series, less chambers are required resulting in less labor and a greater installation area.
 Heavy Duty (HD) versions must be used for traffic applications.
 Our most popular and cost-effective models used for storm water are the 100, 150, 200, 330XL and V6.
 Recharger 330 is available for non-domestic use only. All domestic designs are to use the Recharger 330XL.

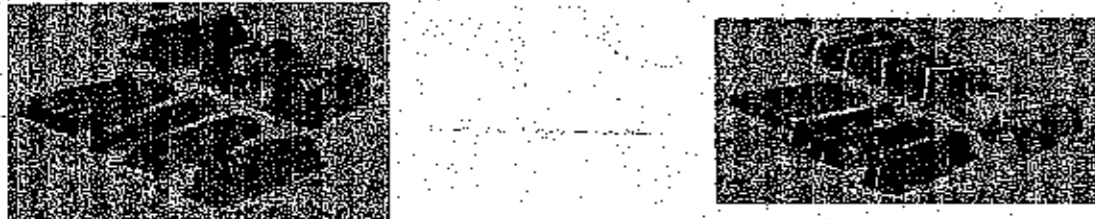

Results 1 - 10 of 10

Model #	Model Name	Length	Installed Length	Width	Height	Max. Storage Capacity Surrounded in Stone
C-4	Contacto® Fixed Drain™ C-4	8.50 ft	8.00 ft	48 inches	8.50 inches	29.88 m³/m
F-224	Contacto® F-224	8.50 ft	8.00 ft	48 inches	12.50 inches	14.06 m³/m
100	Contacto® 100	8.50 ft	7.40 ft	36 inches	12.50 inches	26.88 m³/m
		2.44 m	2.25 m	914 mm	315 mm	0.92 m³/m
125	Contacto® 125	7.50 ft	6.25 ft	30 inches	18.50 inches	25.16 m³/m
		2.29 m	1.91 m	762 mm	467 mm	0.83 m³/m
150	Recharger® 150	8.50 ft	7.50 ft	36 inches	19.50 inches	36.71 m³/m
		2.59 m	2.29 m	914 mm	493 mm	1.24 m³/m
180	Recharger® 180	7.33 ft	6.33 ft	36 inches	20.50 inches	35.37 m³/m
		2.23 m	1.93 m	914 mm	521 mm	1.00 m³/m
280	Recharger® 280	8.50 ft	7.00 ft	48 inches	28.50 inches	64.46 m³/m
		2.44 m	2.13 m	1194 mm	673 mm	1.83 m³/m
330	Recharger® 330	7.50 ft	6.25 ft	52 inches	30.50 inches	70.77 m³/m
		2.29 m	1.91 m	1321 mm	775 mm	2.20 m³/m
330XL	Recharger® 330XL	8.50 ft	7.00 ft	52 inches	30.50 inches	73.26 m³/m
		2.59 m	2.13 m	1321 mm	774 mm	2.24 m³/m
V6	Recharger® V6	8.00 ft	7.50 ft	54 inches	34.00 inches	97.72 m³/m
		2.44 m	2.29 m	1372 mm	861 mm	2.77 m³/m

Results 1 - 10 of 10

1/27/2008 | Page 1 of 2

Storm Water Chamber

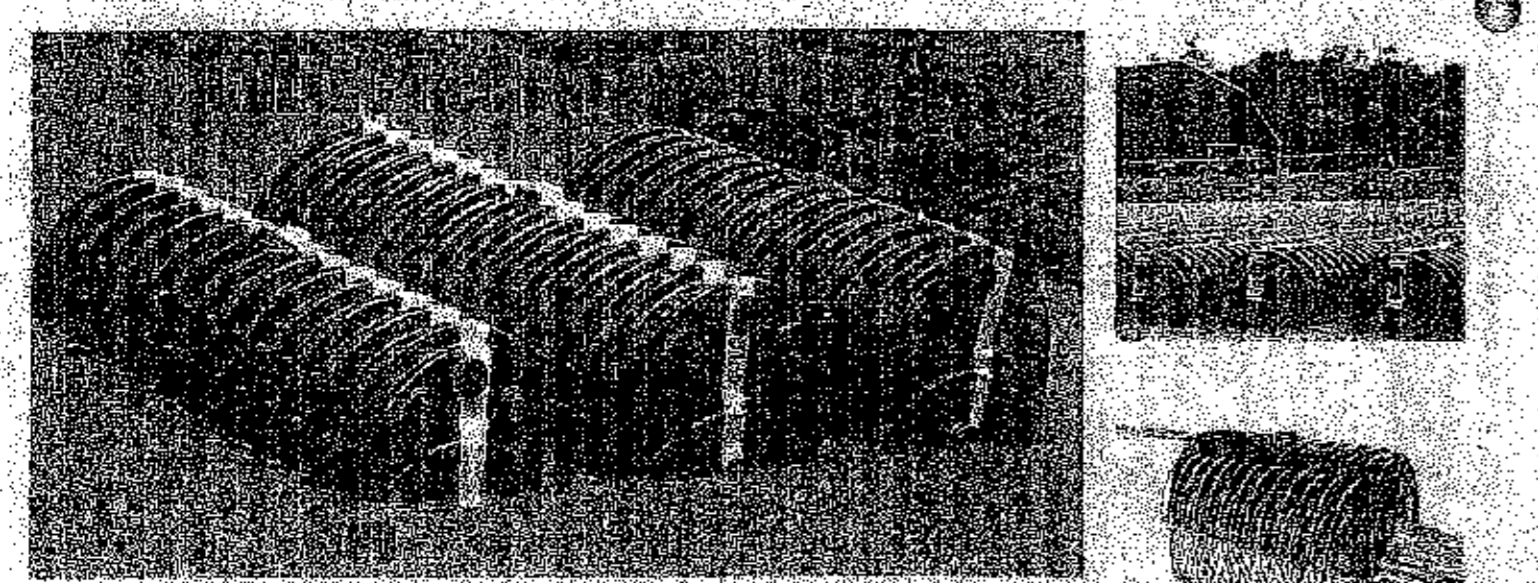

CULTEC Recharger® Chambers are designed for underground stormwater detention/retention or may be used for septic leach fields.
 All models come in heavy duty for use in traffic and non-traffic applications. Their higher profiles work well for applications of large volumes or that need to be contained in smaller areas. The perforated sidewalls and full open bottoms allow for maximum infiltration capability.
 When used with CULTEC No. 410™ Filter Fabric, Recharger® chambers can be used as gravel-less leach fields.

Our unique patented rib connection, found only on CULTEC chambers, makes installation fast and easy. Backfilling reinforces this connection. Recharger® chambers are lightweight and easy to move around the job site. One or two workers can manually place and align. The rib connection is designed to hold to a minimum and there is less and no vibration.

For stormwater, their sub-surface installation saves space while offering design flexibility.



CULTEC chambers are superior to others because they have an integral fully formed endwall. No additional end wall parts are required.

	Recharger® 180	Recharger® 280	Recharger® 330
Height	20.5"	26.5"	30"
Invert Height	14"	20.3"	24"
Width	36"	48"	52"
Length	7.33'	6.0'	6.5'
Lay-up Length	6.33'	7.0'	6.5'
Capacity	189.19 gal	283.89 gal	417.44 gal
Capacity	25.3 C.F.	44.6 C.F.	56.9 C.F.
One unit covers about	400 S.F.	780 S.F.	900 S.F.

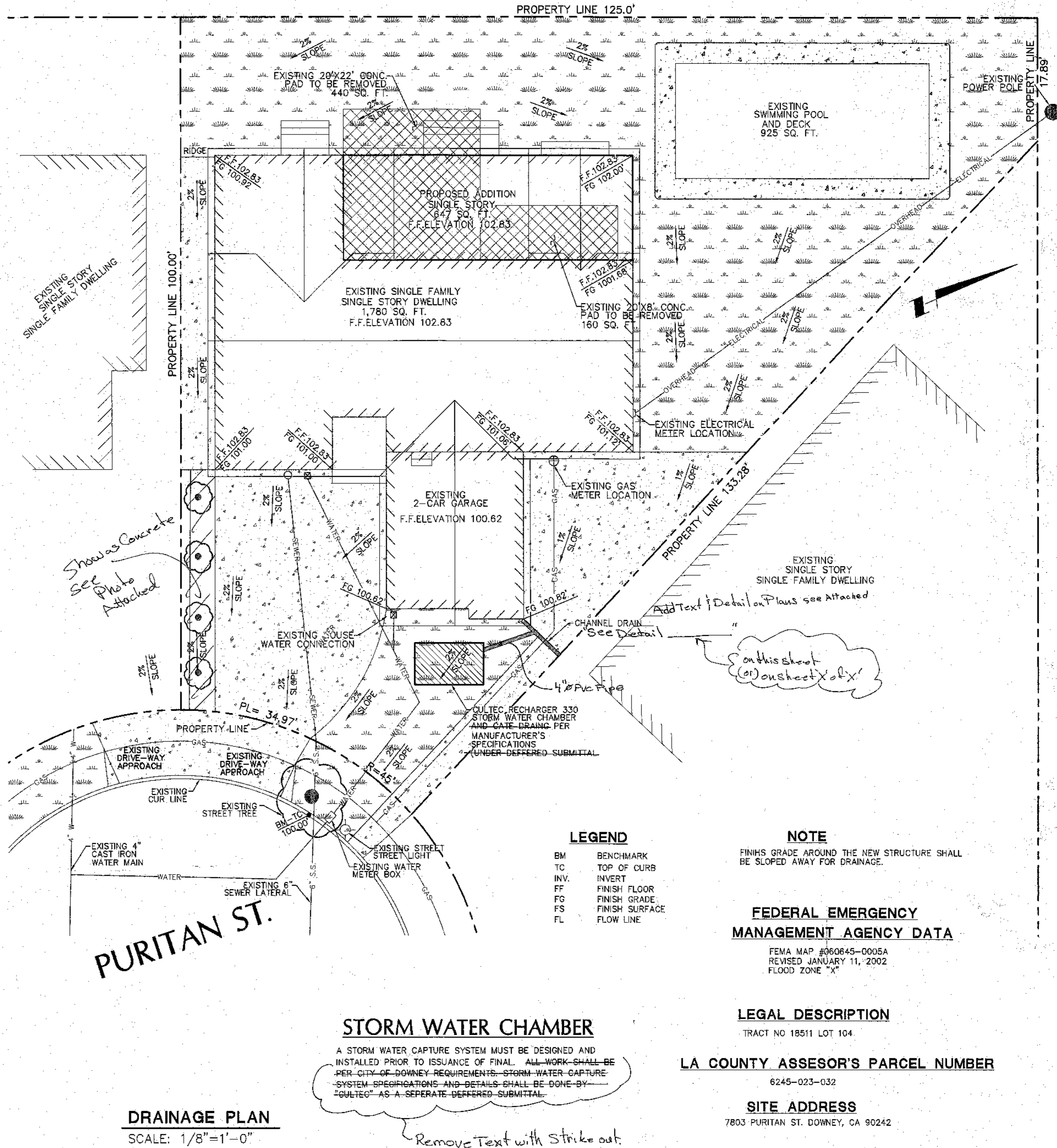
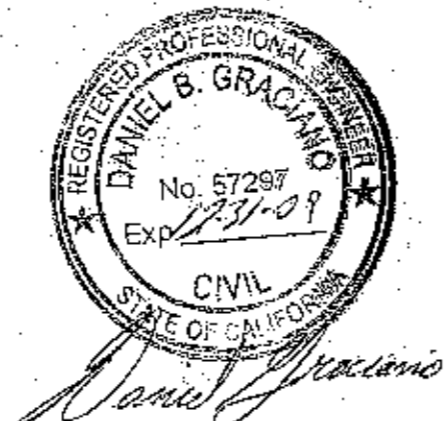

DRAINAGE PLAN
 SCALE: 1/8"=1'-0"

STORM WATER CHAMBER

A STORM WATER CAPTURE SYSTEM MUST BE DESIGNED AND INSTALLED PRIOR TO ISSUANCE OF FINAL. ALL WORK SHALL BE PER CITY OF DOWNEY REQUIREMENTS. STORM WATER CAPTURE SYSTEM SPECIFICATIONS AND DETAILS SHALL BE DONE BY "CULTEC" AS A SEPARATE DEFERRED SUBMITTAL.

LEGEND

BM	BENCHMARK
TC	TOP OF CURB
INV.	INVERT
FF	FINISH FLOOR
FG	FINISH GRADE
FS	FINISH SURFACE
FL	FLOW LINE

NOTE
 FINISH GRADE AROUND THE NEW STRUCTURE SHALL BE SLOPED AWAY FOR DRAINAGE.

FEDERAL EMERGENCY MANAGEMENT AGENCY DATA
 FEMA MAP #060645-0005A
 REVISED JANUARY 11, 2002
 FLOOD ZONE "X"

LEGAL DESCRIPTION
 TRACT NO 18511 LOT 104.

LA COUNTY ASSESSOR'S PARCEL NUMBER
 6245-023-032

SITE ADDRESS
 7803 PURITAN ST. DOWNEY, CA 90242

REVISIONS	BY

GRIFFIN WILLIAM & MARLENE
 HOME IMPROVEMENTS
 7803 PURITAN ST.
 DOWNEY, CA 90242

DRAINAGE PLAN

DATE	05-25-04
SCALE	AS SHOWN
DRAWN	R.G.
JOB	GRIFFIN
SHEET	8
OF 9 SHEETS	