

EXISTING RAISED FLOOR FOUNDATION

EXISTING SLAB ON GRADE

FOUNDATION PLAN
SCALE: 1/4" = 1'-0"

FOUNDATION NOTES:

1. CONCRETE SHALL BE 2500 P.S.I. AT 28 DAYS, WITH TYPE II CEMENT.
2. ANCHOR BOLTS SHALL BE 5/8" X 10" WITH 7" EMBEDMENT IN FOOTING WALL AND SPACED AT 48" O.C. MAX. 1/2" X 3/4" 22G PLATE WASHERS STARTING WITHIN 12" OF SILL CORNERS AND SPLICES.
3. ALL WOOD IN DIRECT CONTACT WITH MASONRY OR CONCRETE AT A POINT WITHIN 48" OF THE GROUND SHALL BE PRESSURE TREATED WITH AN APPROVED PRESERVATIVE OR SHALL BE DURABLE WOOD (FDN. OR CALIF. REDWOOD OR FOUNDATION LUMBER WESTERN RED CEDAR).
4. SATURATE THE SOIL 18 INCHES DEEP BEFORE PLACING THE CONCRETE SLAB.
5. WOOD SHALL BE 8" MINIMUM ABOVE FINISH GRADE.
6. SURFACE WATER SHALL DRAIN AWAY FROM BUILDING.
7. FASTENERS FOR PRESERVATIVE TREATED WOOD SHALL BE OF HOT DIPPED ZINC-COATED GALVANIZED STEEL, STAINLESS STEEL, SILICON BRONZE, OR COPPER PER CBC SECTION 2504.4.3.
8. HOLD-DOWN HARDWARE MUST BE SECURED IN PLACE PRIOR TO FOUNDATION INSPECTION.

ANCHOR BOLTS

5/8" X 10" A-307 ANCHOR BOLTS AT 48" O.C. AND 12" FROM ALL ENDS UNLESS SPECIFIED OTHERWISE IN SHEAR WALL SCHEDULE. SEE SHEAR WALL PLAN FOR ANCHOR BOLT REQUIREMENTS IN SHEAR WALLS.

HOLD-DOWN CONNECTORS

1. HOLD-DOWN HARDWARE MUST BE SECURED IN PLACE PRIOR TO FOUNDATION INSPECTION.
2. HOLD-DOWN CONNECTOR BOLTS INTO WOOD FRAMING REQUIRE APPROVED PLATE WASHERS.
3. HOLD-DOWNS SHALL BE TIGHTENED JUST PRIOR TO COVERING THE WALL FRAMING.

STEEL REINFORCEMENT

STEEL REINFORCEMENT (REBAR) SHALL BE GRADE 40 DEFORMED

FOUNDATION CONSTRUCTION NOTES:

1. EPOXY SET 5/8" ALL THREAD STEEL ROD - HILTI EPOXY RESO 500 ICC# ESR-2322 - 10" MIN. EMBEDMENT PER DETAIL 6
2. EPOXY SET 5/8" ALL THREAD STEEL ROD - HILTI EPOXY RESO 500 ICC# ESR-2322 - 10" MIN. EMBEDMENT PER DETAIL 7
3. SIMPSON SSTB 16 HOLD-DOWN ANCHOR ROD
4. CONCRETE PILAR PER DETAIL 4
5. CONNECT TO EXISTING FOOTING PER DETAIL 2
6. CONNECT GIRDER TO FOOTING PER DETAIL 1
7. 18" WIDE X 24" HIGH OPENING FOR CRAWL HOLE (SUB-FLOOR ACCESS)
8. 30" SQUARE PAD FOOTING PER DETAIL 3
9. 24" SQUARE PAD FOOTING PER DETAIL 3
10. NEW 18" WIDE BY 24" HIGH SUB-FLOOR CRAWL HOLE ACCESS

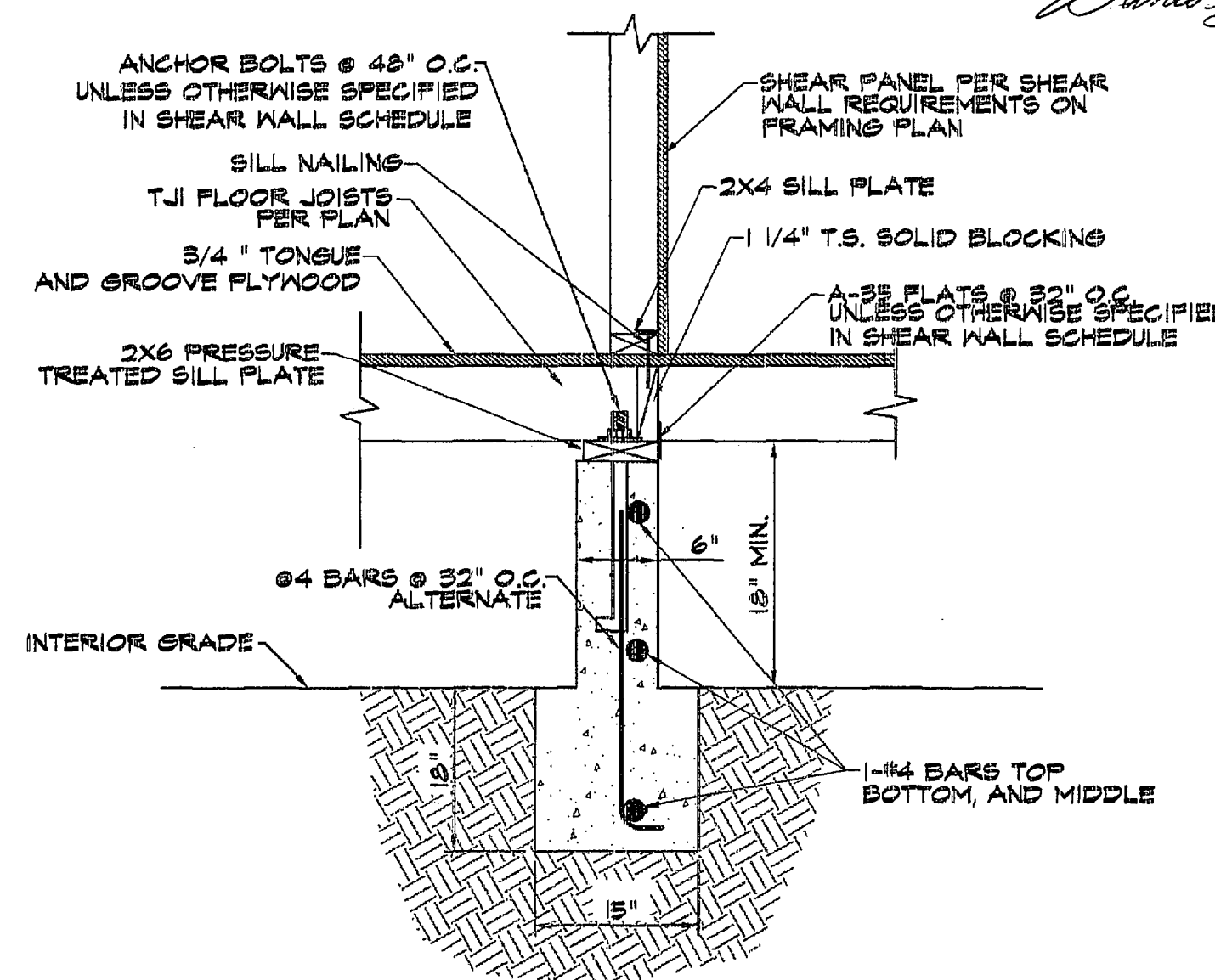

DETAIL 5
NO SCALE

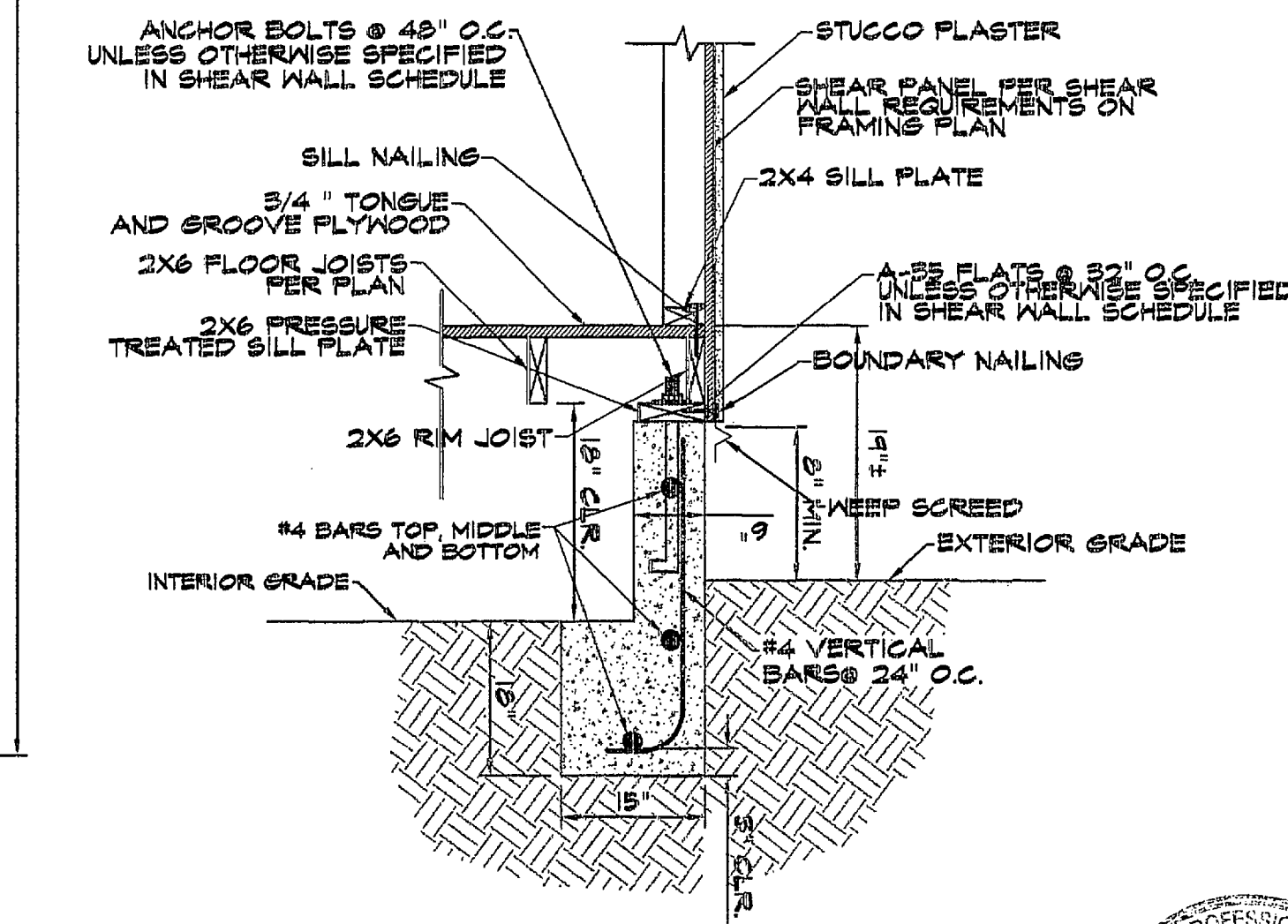

DETAIL 3
NO SCALE

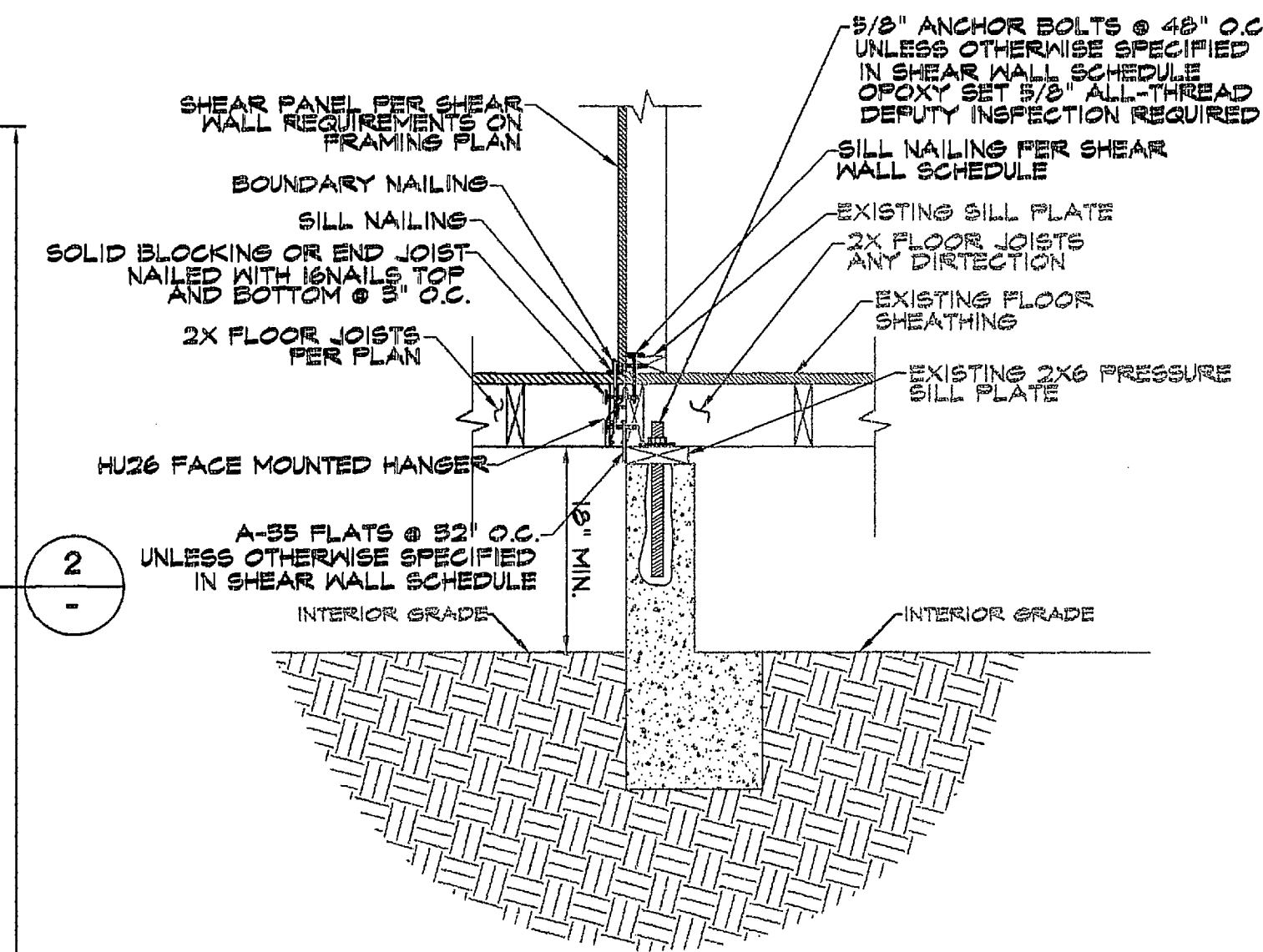

DETAIL 1
NO SCALE

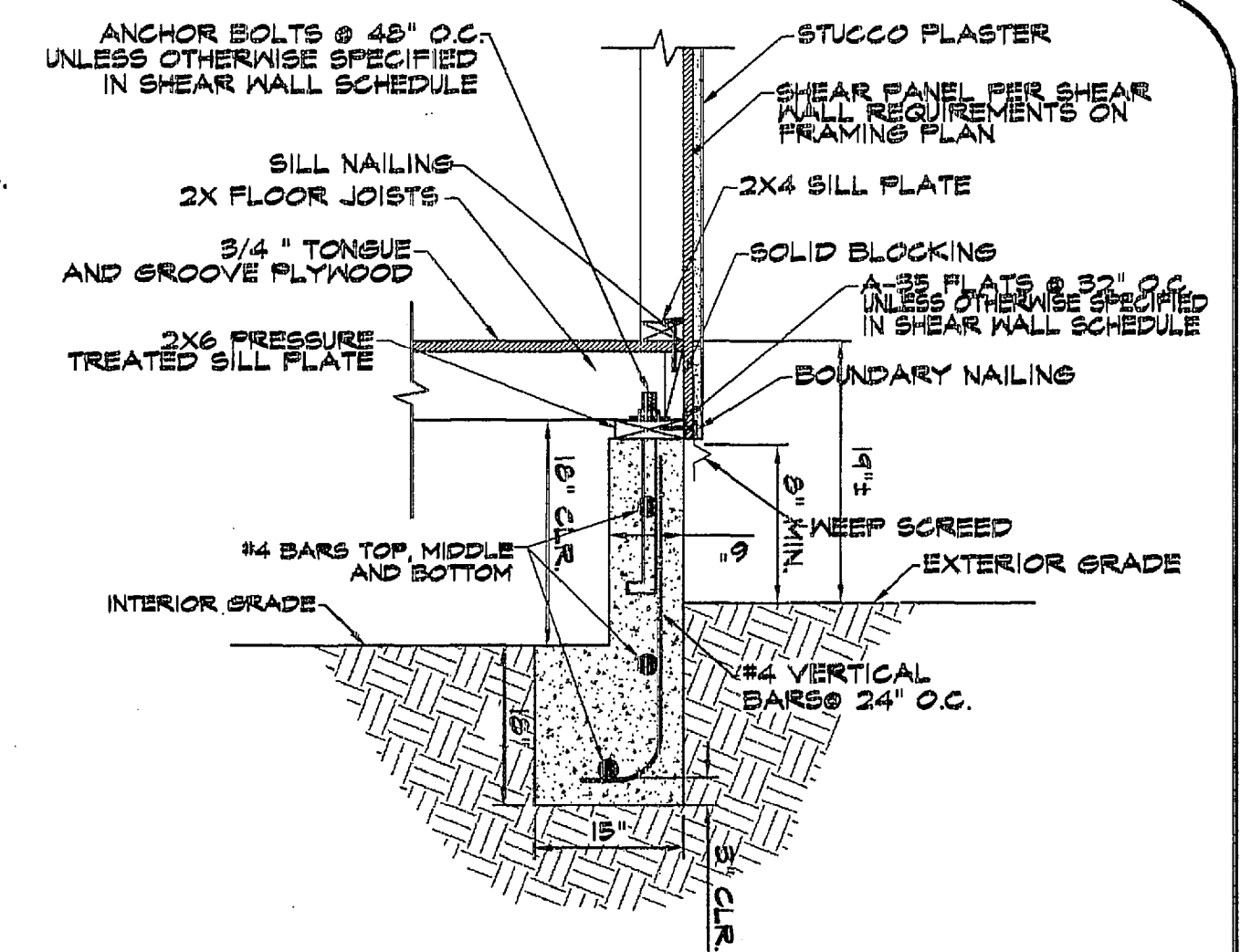

DETAIL 2
NO SCALE

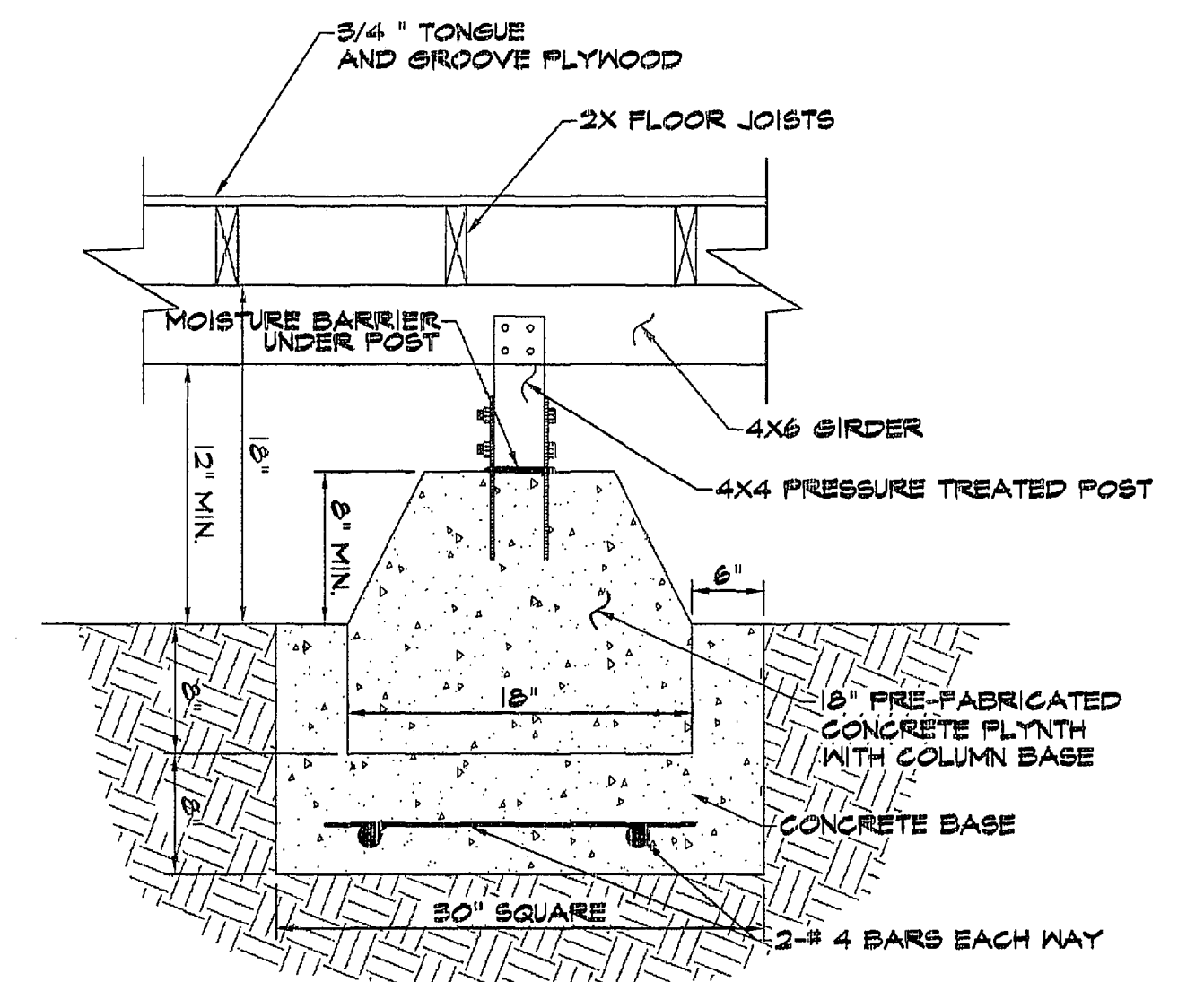

DETAIL 4
NO SCALE

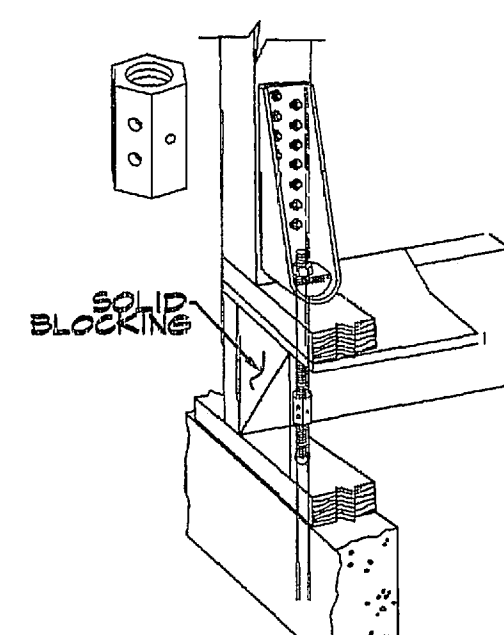

HOLD-DOWN ANCHOR BOLTS

HOLD-DOWN MODEL	SSTB ANCHOR BOLT (NEW FOUR)	ALL-THREAD ANCHOR BOLT (EPOXY SET)
PHD2	SSTB14	5/8" 10" EMBEDMENT
PHD5	SSTB20	5/8" 10" EMBEDMENT
PHD6	SSTB28	7/8" 15" EMBEDMENT
HD08	SSTB28	7/8" 15" EMBEDMENT

EPOXY USED SHALL BE "HILTI" RESO 500 ICC# ESR-2322.

TYPICAL HOL-DOWN DETAILS (RAISED FLOOR)
NO SCALE

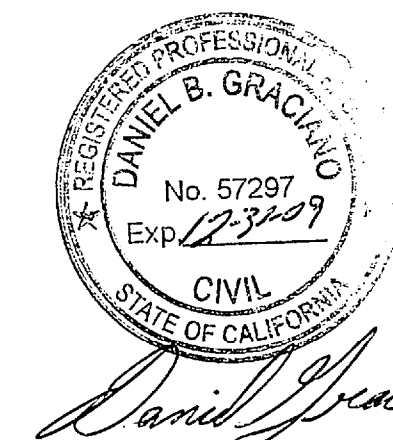

GRIFFIN, WILLIAM & MARLENE
HOME IMPROVEMENTS
1803 PURITAN ST.
DOWNEY, CA 90242

FOUNDATION PLAN AND DETAILS

DATE	01-28-09
SCALE	AS SHOWN
DRAWN	R.G.
JOB	GRIFFIN
SHEET	4
OF 8 SHEETS	